



An Exelon Company

Appendix X

Cooling Tower Basins Remedial Action: Sampling Results and Excavation Area

Project Management Initials: _____ Designer: _____ Checked: _____ Approved: _____



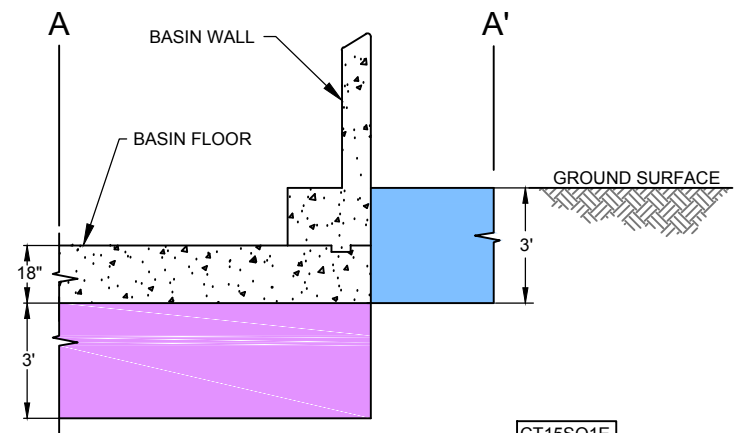

SECTION DETAIL A - A' (TYP.)
SCALE: 1" = 5'

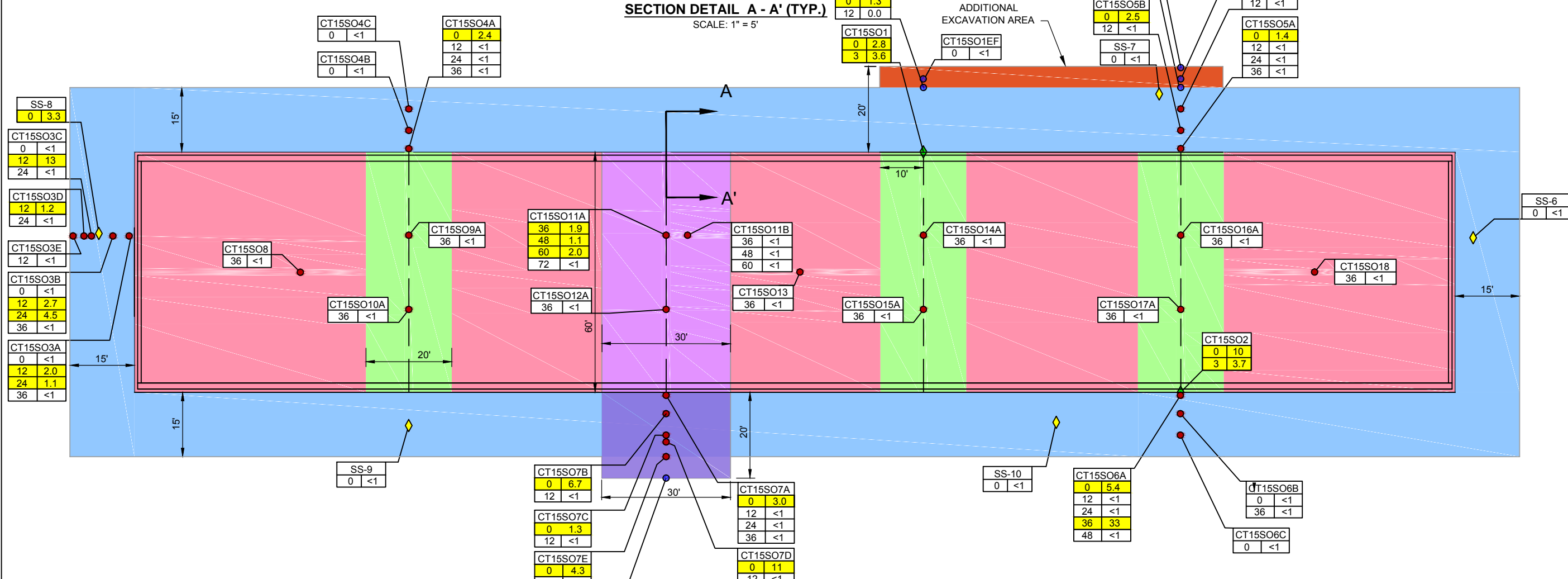

COOLING TOWER 15 - PLAN VIEW
SCALE: 1" = 25'

LEGEND:

- 2017 CONFIRMATORY SAMPLING LOCATION
- 2014-2015 SAMPLING LOCATION
- ◆ 2013 SAMPLING LOCATION
- ◆ 2012 SAMPLING LOCATION
- EXPANSION JOINT
- PCBs POLYCHLORINATED BIPHENYLS
- mg/kg MILLIGRAMS PER KILOGRAM

NOTE: FOR EXTERIOR SAMPLES, LETTERS AT THE END OF THE SAMPLE ID INDICATE DISTANCE FROM THE BASIN AS FOLLOWS: A=0', B=5', C=10', D=12', E=15', EF=17', F=20', G=22".

DATA BOX KEY:

| Sample ID (SO = Soil) | |
|------------------------|--------------------|
| Depth below grade (in) | Total PCBs (mg/kg) |
| 0 | 1.1 |
| 12 | <1 |

NOTE: RESULTS HIGHLIGHTED IN **YELLOW** INDICATE A TOTAL PCBs CONCENTRATION GREATER THAN OR EQUAL TO 1 mg/kg.

APPROXIMATE EXCAVATION AREAS AND TONNAGE:

| REMEDIATION AREA | AREA (ft ²) | DEPTH (ft) | VOLUME (cy) | MASS (tons) |
|------------------|-------------------------|------------|--------------|--------------|
| [Orange Box] | 392 | 1.0 | 15 | 22 |
| [Blue Box] | 11,490 | 3.0 | 1,277 | 1,915 |
| [Purple Box] | 600 | 3.0 | 67 | 100 |
| [Red Box] | 13,080 | 0.5 | 242 | 363 |
| [Green Box] | 3,600 | 1.0 | 133 | 200 |
| [Purple Box] | 1,800 | 3.0 | 200 | 300 |
| TOTALS | 30,570 | | 1,934 | 2,900 |

NOTE: ALL REMEDIATION AREAS ARE BELOW GRADE. [Green Box] [Red Box] AREA IS BELOW BASE OF BOTTOM SLAB AND INSIDE THE BASIN.

DATE
2017.08.07

PROJECT NUMBER
60340344

FIGURE TITLE
Cooling Tower 15
Sampling Results and
Excavation Area

FIGURE NUMBER

2

Project Management Initials: _____ Designer: _____ Checked: _____ Approved: _____

Last saved by: MELANIE.CALVO(2017-08-09) Last Plotered: 2017-08-09
Filename: L:\GROUP\CARTHEPEPCO - 60287343\COOLING TOWER 15 - FIGURE 1 - SAMPLE RESULTS_2014.DWG

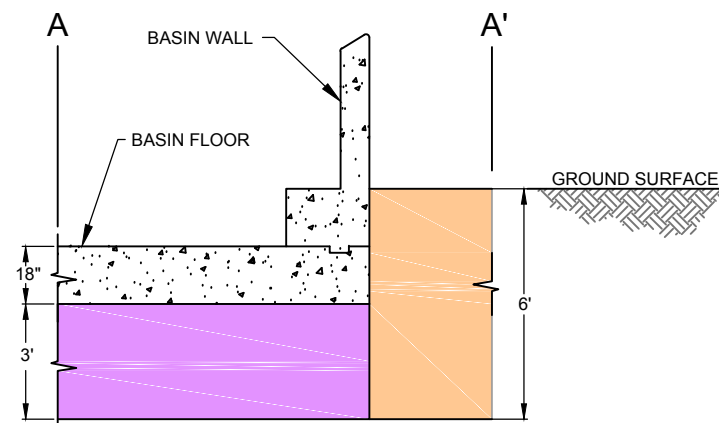

SECTION DETAIL A - A' (TYP.)
SCALE: 1" = 5'

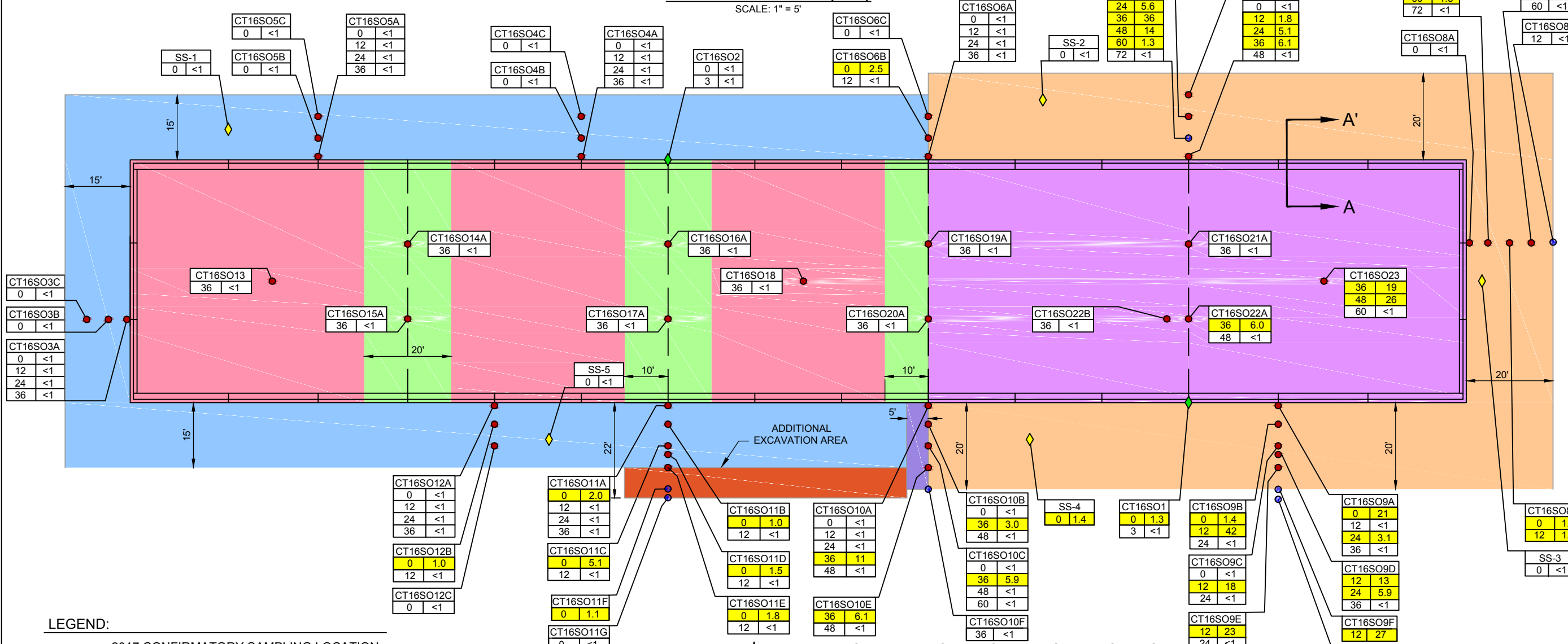

APPROXIMATE EXCAVATION AREAS AND TONNAGE:

| REMEDIATION AREA | AREA (ft ²) | DEPTH (ft) | VOLUME (cy) | MASS (tons) |
|-------------------|-------------------------|------------|--------------|--------------|
| [Red Area] | 456 | 1.0 | 17 | 26 |
| [Blue Area] | 6,819 | 3.0 | 758 | 1,137 |
| [Orange Area] | 6,728 | 6.0 | 1,495 | 2,243 |
| [Purple Area] | 7,392 | 3.0 | 821 | 1,232 |
| [Pink Area] | 8,088 | 0.5 | 150 | 225 |
| [Green Area] | 3,000 | 1.0 | 111 | 167 |
| [Light Blue Area] | 100 | 4.0 | 15 | 22 |
| TOTALS | 31,127 | | 3,367 | 5,052 |

NOTE: ALL REMEDIATION AREAS ARE BELOW GRADE. [Color Key] AREA IS BELOW BASE OF BOTTOM SLAB AND INSIDE THE BASIN.

- LEGEND:**
- 2017 CONFIRMATORY SAMPLING LOCATION
 - 2014-2015 SAMPLING LOCATION
 - ◆ 2013 SAMPLING LOCATION
 - ◆ 2012 SAMPLING LOCATION
 - EXPANSION JOINT
 - PCBs POLYCHLORINATED BIPHENYLS
 - mg/kg MILLIGRAMS PER KILOGRAM

DATA BOX KEY:

| Sample ID (SO = Soil) | |
|------------------------|--------------------|
| Depth below grade (in) | Total PCBs (mg/kg) |
| 0 | 1.1 |
| 12 | <1 |

NOTE: RESULTS HIGHLIGHTED IN **YELLOW** INDICATE A TOTAL PCBs CONCENTRATION GREATER THAN OR EQUAL TO 1 mg/kg.

NOTE: FOR EXTERIOR SAMPLES, LETTERS AT THE END OF THE SAMPLE ID INDICATE DISTANCE FROM THE BASIN AS FOLLOWS: A=0', B=5', C=10', D=12', E=15', EF=17', F=20', G=22".

DATE
2017.08.07

PROJECT NUMBER
60340344

FIGURE TITLE
Cooling Tower 16
Sampling Results and
Excavation Area

FIGURE NUMBER
3

Project Management Initials: _____ Designer: _____ Checked: _____ Approved: _____
 Last saved by: MELANIE.CALVO(2017-08-09) Last Printed: 2017-08-09
 Filename: L:\GROUP\CARTHEPEPCO - 60287343\COOLING TOWER 16 - FIGURE 2 - SAMPLE RESULTS_2014.DWG